

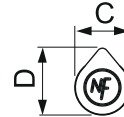

### CUSCINETTO / BEARING

Materiale: Acciaio grezzo

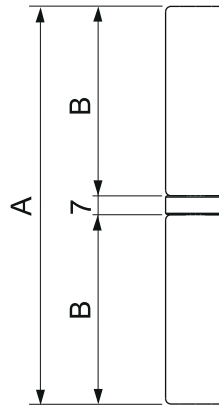

- Drop profile parisienne hinge with steel, stainless steel or brass pin, with thrust bearing
- Charnière parisienne profil en goutte avec pivot acier, acier inox ou laiton, avec palier de butée
- Bisagra à perfil de gota con perno interior en acero, acero inox o latón, con rodamiento
- Петля PARAGINA со стальным штифтом (нержавеющая сталь, латунь) с подшипником
- Pariser Anschweißband mit Kugellager. Aus Stift aus Stahl, Edelstahl oder Messing.



Profilo stampato 18 x 22mm

Printed profile 18x22mm

TESTED

Profilo stampato 20 x 25mm

Printed profile 20x25mm

Profilo stampato 22 x 25mm

Printed profile 22x25mm

Art.	A	B	C	D	Perno	Peso(g)	Conf.	Ø Perno
-	-	-	-	-	Pin	Weight(g)	Pack	Ø Pin
197/18.1.4	147	70	18	22	inox	252	25	10
197/18.2.4	147	70	18	22	acciaio steel	252	25	10
197/18.3.4	147	70	18	22	ottone brass	255	25	10
197/20.1.4	147	70	20	25	inox	330	20	12
197/20.2.4	147	70	20	25	acciaio steel	330	20	12
197/20.2.4.140	140	66.5	20	25	acciaio steel	318	20	12
197/20.3.4	147	70	20	25	ottone brass	333	20	12
197/22.1.4	147	70	22	25	inox	368	15	14
197/22.2.4	147	70	22	25	acciaio steel	368	15	14
197/22.3.4	147	70	22	25	ottone brass	374	15	14