



Materiale: Acciaio Zincato



1 Cuscinetto schermato

1 Ball bearing | 1 Roulement | 1 Rodamiento

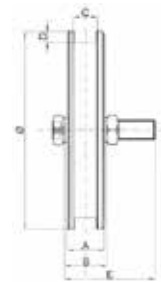
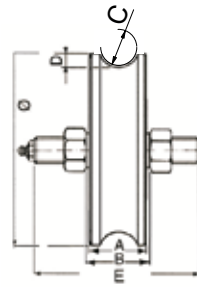
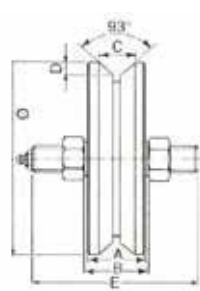

One ball bearing galvanized steel wheel with lubricator

Galet en acier zingué avec pivot graisseur, une roulement

Rueda en acero cincado con un rodamiento y lubricador

Колесо с двумя подшипниками V

Schiebepore Rolle aus verzinktem Stahl mit Schmiernippel und einem Kugellager

N.B. Per ordinare la versione Cataforesi aggiungere la lettera "C" alla fine del codice Es: 111/5/17C

Le versioni nylon sono indicate con la lettera "N" finale

To order the Cataphoresis model, add "C" at the end of the code. Ex.: 110/5/17C

The nylon versions are indicated with the final letter "N"

INOX

NYLON



Art.	Ø	A	B	C	D	E	Peso(g)	Conf.
-	-	-	-	-	-	-	Weight(g)	Pack
106/8/25	80	25	44	20	7,5	16x80	790	8
106/10/25	100	25	44	20	7,5	16x80	1.300	6
106/12/25	120	25	44	20	7,5	16x80	1.930	6
106/14/25	140	25	44	20	7,5	16x80	2.700	6



Art.	Ø	A	B	C	D	E	Peso(g)	Conf.
-	-	-	-	-	-	-	Weight(g)	Pack
107/8/25	80	25	44	20	10	16x80	790	8
107/10/25	100	25	44	20	10	16x80	1.300	6
107/12/25	120	25	44	20	10	16x80	1.930	6
107/14/25	140	25	44	20	10	16x80	2.700	6

